

ENGLISH

150 YEARS | AMERICAN MUSEUM  
OF NATURAL HISTORY

# Visitor Map

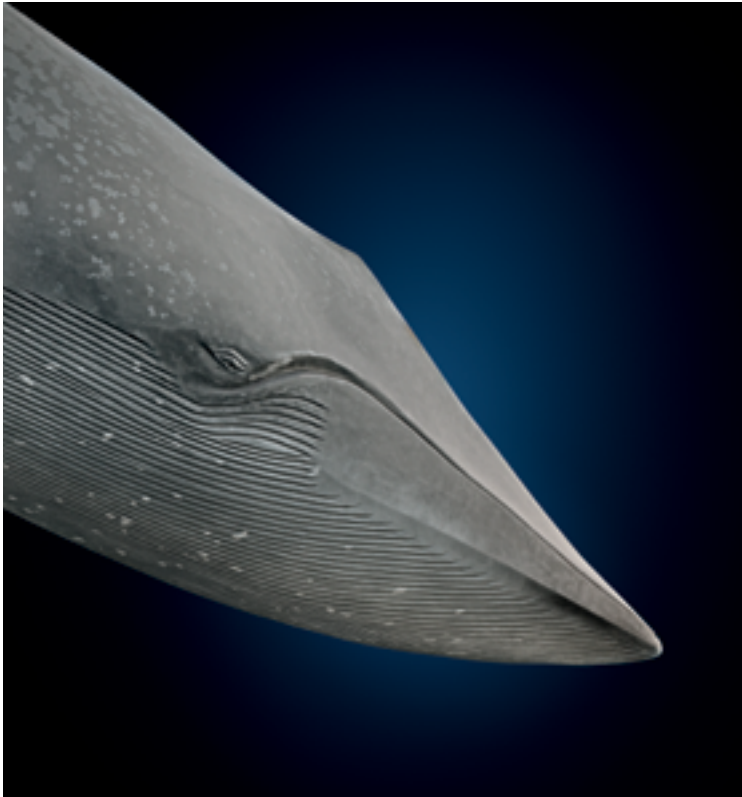

Download **Explorer**, the Museum's free mobile app! Get a map, turn-by-turn directions, recommendations for what to see, and more!

Visit [amnh.org/getMap](http://amnh.org/getMap)  
from your phone

Text **getMap** to **33222**

Launch the camera app on your  
phone and point it here for a link:



## Shop

Availability subject to change.

**THE MUSEUM SHOP** 1st and 2nd Floor

**PLANETARIUM SHOP** Lower Level, Rose Center for Earth and Space

**COSMIC SHOP** 2nd Floor, Rose Center for Earth and Space

**DINO STORE** 4th Floor

**ONLINE STORE** Visit [shop.amnh.org](http://shop.amnh.org) for unique gifts.

## Dine

Availability subject to change.

**FOOD COURT** Lower Level

**CAFÉ ON ONE** 1st Floor

**CAFÉ ON 4** 4th Floor

## Download Explorer

Download Explorer, the Museum's free mobile app! Get a map, turn-by-turn directions, recommendations for what to see, and more!

Supported by **Bloomberg Philanthropies**.

## Join

Apply your tickets toward a Museum Membership! Visit any Membership Desk or call 212-769-5606 to become a Member and enjoy unlimited free General Admission and special exhibition tickets, special access, and more.

## Follow Us On

 [facebook.com/naturalhistory](https://facebook.com/naturalhistory)

 [youtube.com/amnhorg](https://youtube.com/amnhorg)

 [@AMNH](https://twitter.com/AMNH)

 [@amnh](https://instagram.com/amnh)

A Guide to Museum Exhibitions and Facilities

**AMNH.ORG**

LL

# LOWER LEVEL

Columbus Avenue

West 77th Street

West 81st Street

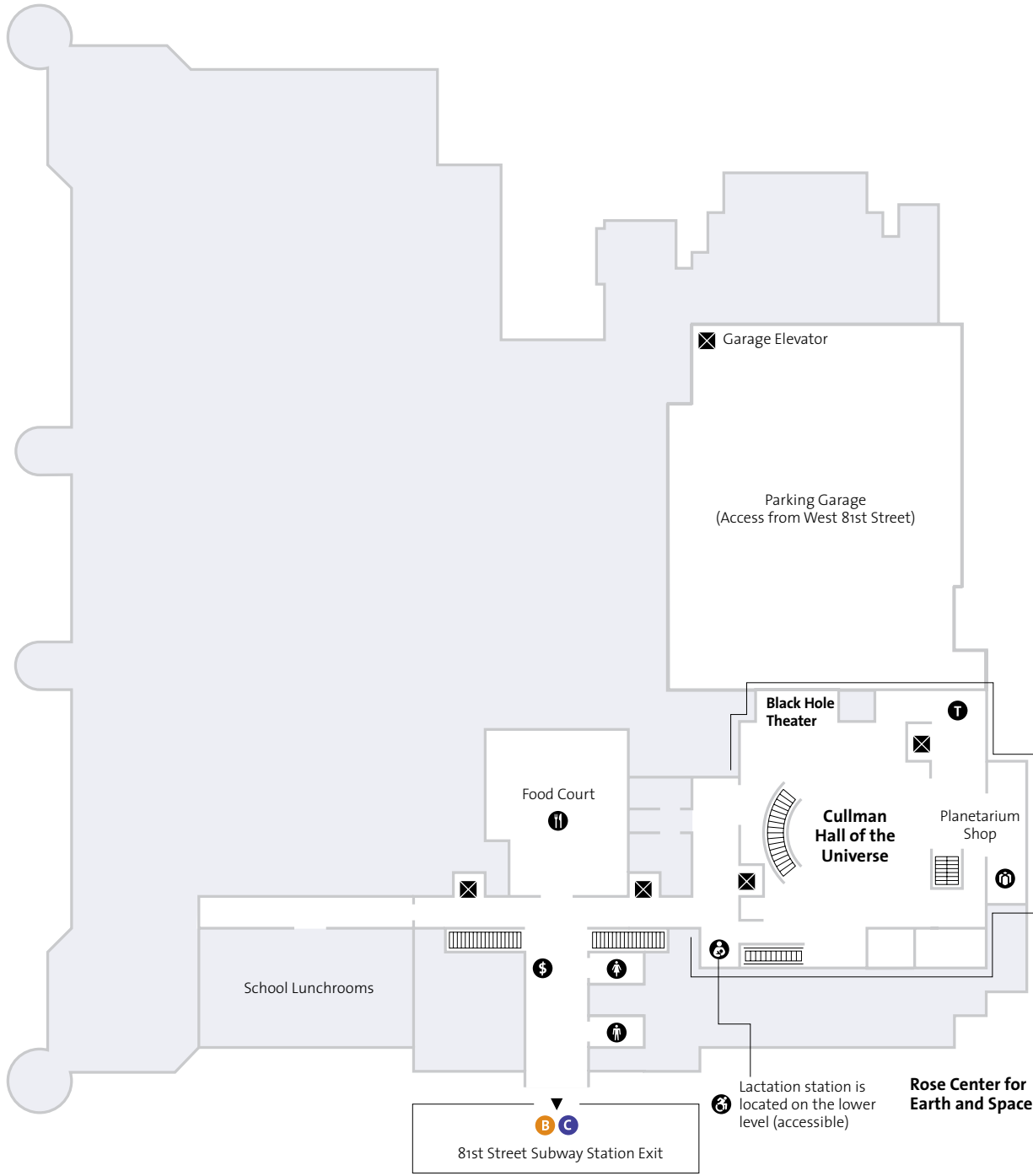

School Lunchrooms

Food Court

Black Hole Theater

Cullman Hall of the Universe

Planetary Shop

Garage Elevator

Parking Garage  
(Access from West 81st Street)

81st Street Subway Station Exit

Lactation station is located on the lower level (accessible)

**Rose Center for Earth and Space**

Central Park West

Columbus Avenue

**Special Exhibition**  
Visit [amnh.org/exhibitions](http://amnh.org/exhibitions)  
for current special exhibitions.

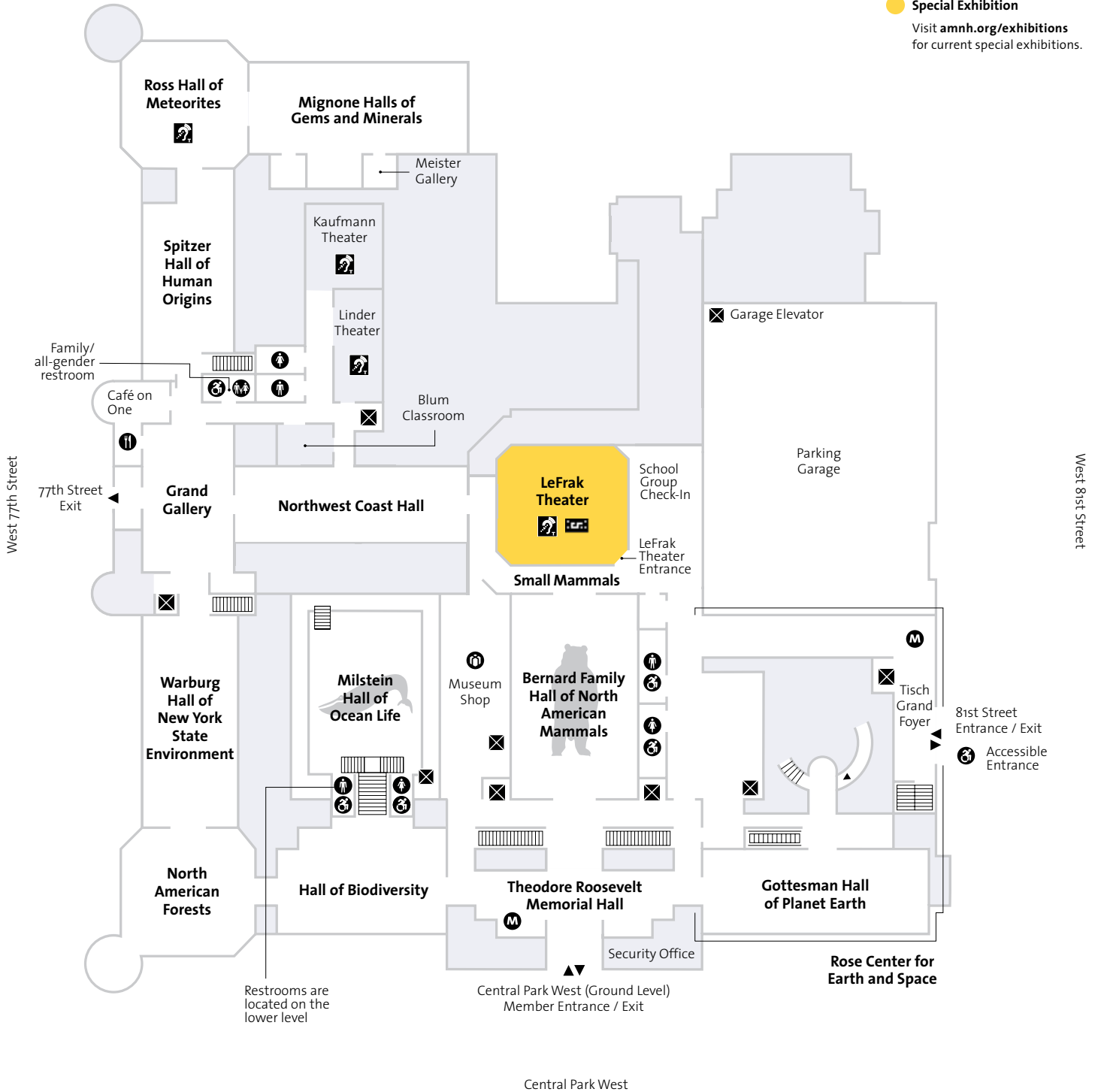

Columbus Avenue

**Special Exhibition**  
Visit [amnh.org/exhibitions](http://amnh.org/exhibitions)  
for current special exhibitions.

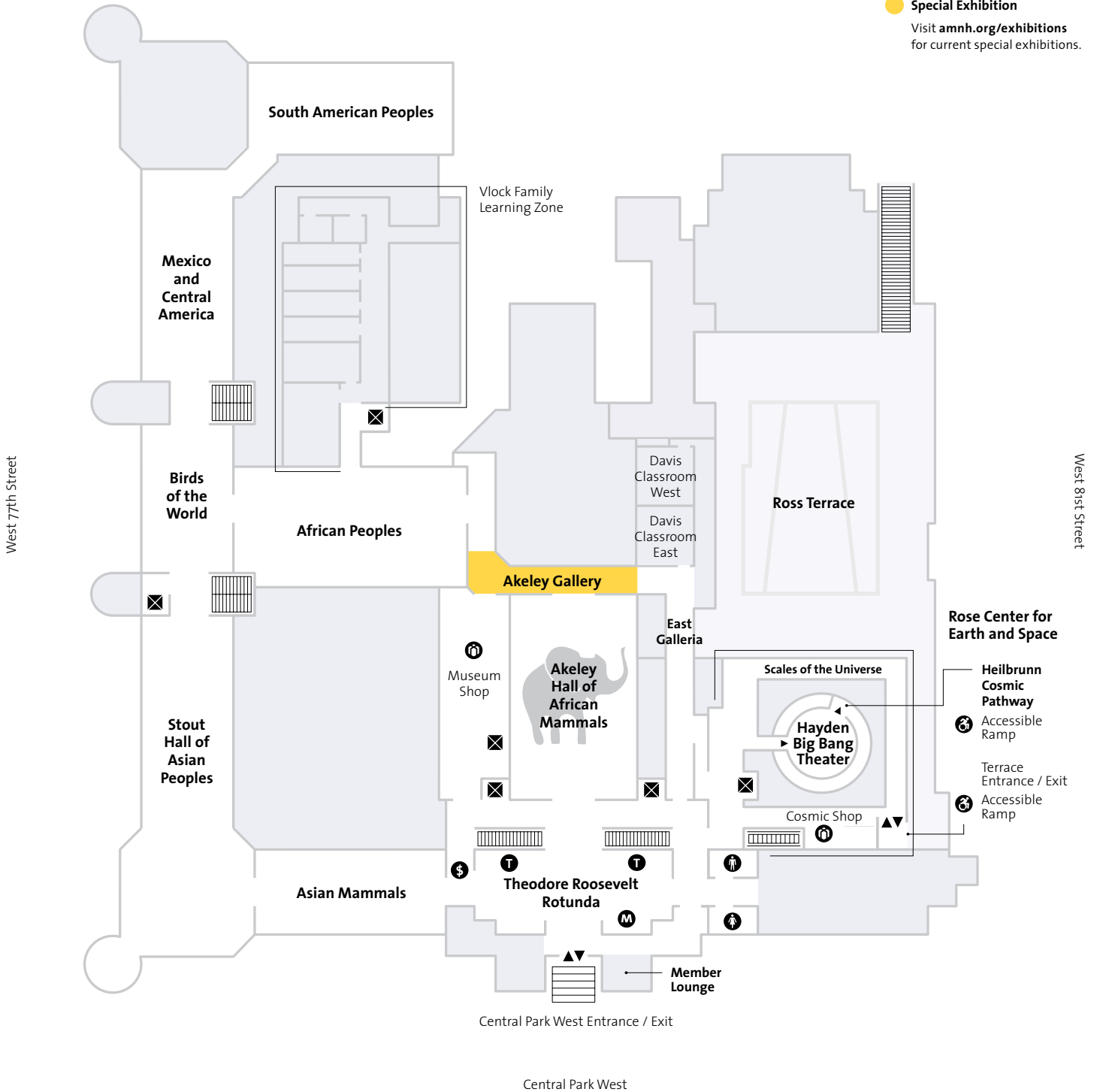

Columbus Avenue

**Special Exhibition**  
Visit [amnh.org/exhibitions](http://amnh.org/exhibitions)  
for current special exhibitions.

West 77th Street

West 81st Street

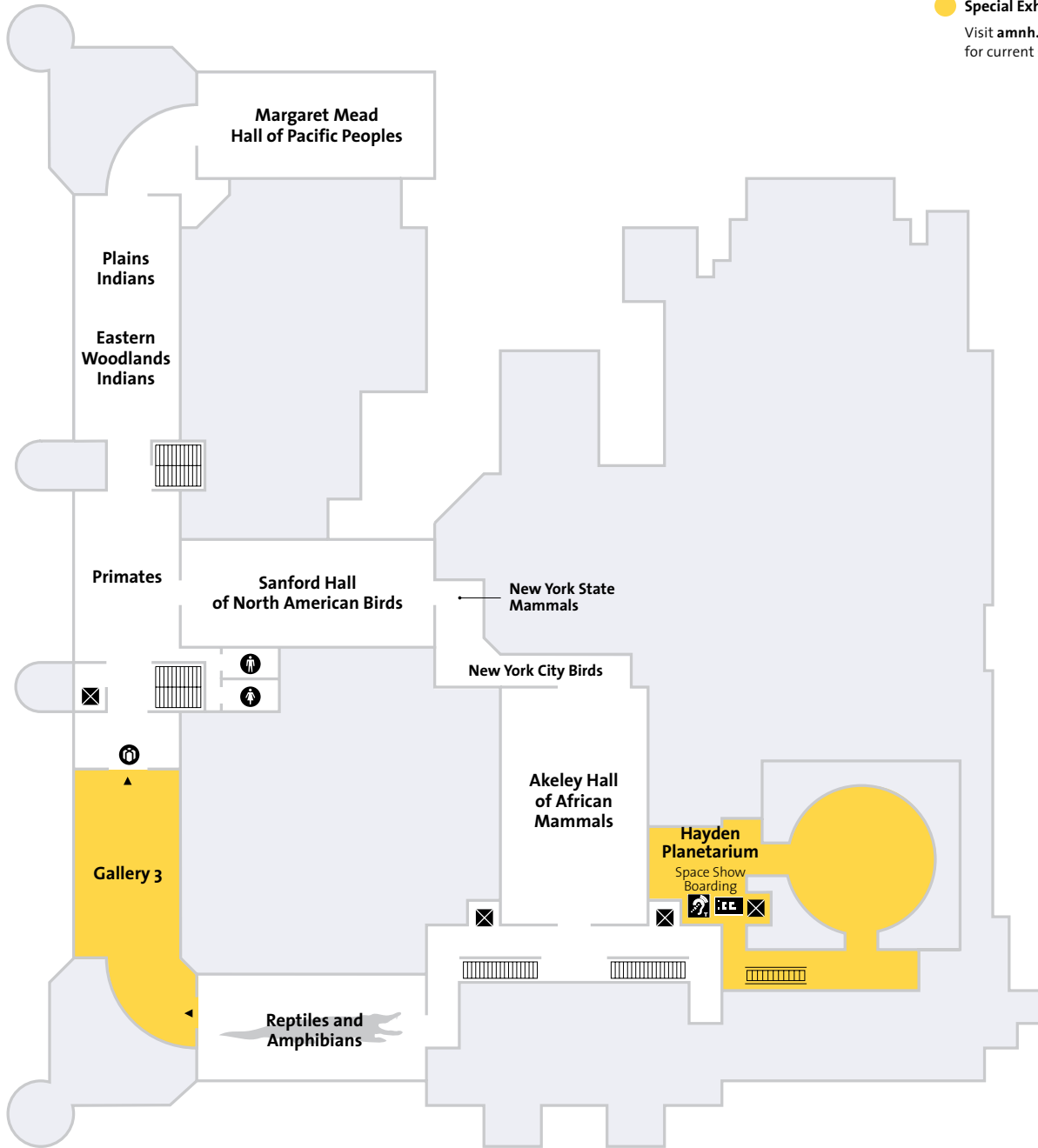

Central Park West

Columbus Avenue

**Special Exhibition**  
Visit [amnh.org/exhibitions](http://amnh.org/exhibitions)  
for current special exhibitions.

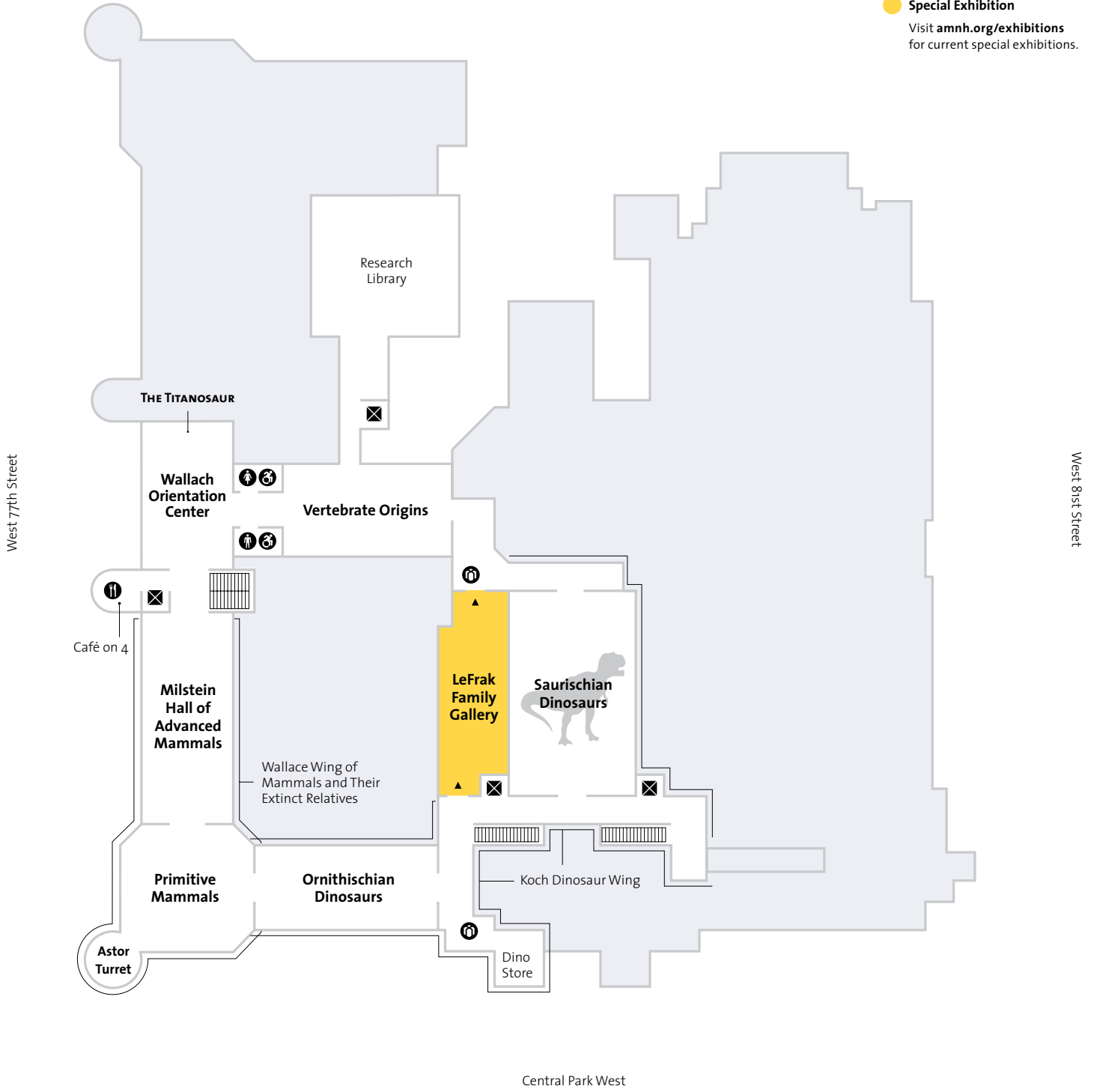

---

The American Museum of Natural History is a private not-for-profit educational institution supported by admission fees, membership, and contributions. The City of New York owns the Museum buildings and the land on which they sit and provides funds for their operation and maintenance.

---

For more information or to purchase tickets, visit [amnh.org](http://amnh.org) or call 212-769-5200. All hours and programs are subject to change.

American Museum of Natural History  
200 Central Park West | New York, New York 10024-5102  
212-769-5100 | [amnh.org](http://amnh.org)

© 2022 American Museum of Natural History

---



Printed in the USA using 100% renewable, non-polluting wind power on recycled Forest Stewardship Council®-certified paper.

## Museum Hours

Open daily, 10 am–5:30 pm. Closed Thanksgiving Day and Christmas Day. Hours subject to change.

	INFORMATION
	TICKET SALES
	WOMEN'S RESTROOM/CHANGING STATION
	MEN'S RESTROOM/CHANGING STATION
	FAMILY/ALL-GENDER RESTROOM/CHANGING STATION
	LACTATION STATION
	ENTRANCE / EXIT
	STAIRS
	ESCALATOR
	ELEVATOR
	AUTOMATED TELLER MACHINE
	MUSEUM STORE
	RESTAURANT
	COAT CHECK
	MEMBER SERVICES

## Accessibility

The Rose Center entrance is wheelchair accessible. All public areas in the Museum are accessible to wheelchairs. All video displays are captioned. It is suggested that visitors bring their own headphones or neck loops to use with assisted listening devices. Closed captioning is available for the Space Show and for the giant-screen film. Space Show, Big Bang Theater, and giant-screen film transcripts are available.

	ACCESSIBLE
	ASSISTIVE LISTENING DEVICES AVAILABLE
	CLOSED CAPTIONING AVAILABLE

## Photography

Photography for personal use is allowed with handheld cameras (except where noted) and with available light or electronic flash attachments. Tripods and lights may not be used. For the safety of visitors and exhibits, selfie sticks are not permitted. Reproduction or sale of photographs is not allowed without permission. Photography is not allowed in the Hayden Planetarium Space Theater or the Samuel J. and Ethel LeFrak Theater.