

American Museum
of Natural History

Center for
Biodiversity and
Conservation

The Marshall M. Weinberg

STUDENT CONFERENCE ON CONSERVATION SCIENCE NEW YORK

October 9–11, 2024



Conference Program

The Marshall M. Weinberg

STUDENT CONFERENCE ON CONSERVATION SCIENCE — NEW YORK

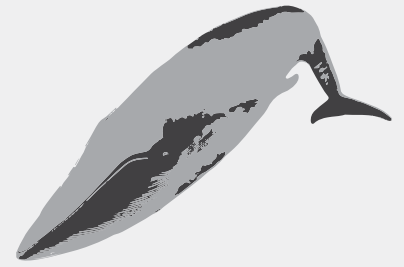

Major funding for the 2024 Student Conference on Conservation Science – New York (SCCS-NY) has been provided by Marshall M. Weinberg. In grateful recognition of his longstanding generosity toward the Center for Biodiversity and Conservation, this year's SCCS-NY is presented in his honor.

Conference Partner:

Yale SCHOOL OF THE ENVIRONMENT

Conference Contributors:

Pace University, Dyson School of Arts and Sciences

Conference Prize Contributors:

Society for Conservation Biology
Yale University Press

For access to the conference platform (including pre-recorded presentation videos, digital versions of posters, presentation titles, authors, and abstracts, presenter Q&A, and mentor feedback as well as full list of workshops, Mentor Cafés, and collection tours), please visit:
<https://resources.cbc.amnh.org/sccsny/participant/>



Share your experience using #SCCSNY2024

Follow us on Facebook: [facebook.com/CBC.AMNH](https://www.facebook.com/CBC.AMNH)

Follow us on X: [@CBC_AMNH](https://twitter.com/CBC_AMNH)

LinkedIn: [linkedin.com/showcase/center-for-biodiversity-and-conservation/](https://www.linkedin.com/showcase/center-for-biodiversity-and-conservation/)

bit.ly/sccsny2024-evaluation

Please fill out our evaluation form by October 18th:

All responses are kept anonymous. Your comments and feedback will help us improve future conferences. We appreciate your time, and we hope you enjoyed SCCS-NY 2024!



Table of Contents

Code of Conduct.....4

COVID-19 and Community Care at SCCS-NY.....5

Conference Agenda.....6

Keynote Speaker.....13

Poster Presenters.....14

SCCS-NY Advisors, Reviewers, Mentors.....15

Museum Map.....18

Acknowledgments

The Student Conference on Conservation Science (SCCS) is the only international conference designed for graduate students, postdoctoral fellows, and early-career professionals pursuing or considering the field of conservation science. Interactions with established conservationists encourage collaborations and advance research.

The Marshall M. Weinberg Student Conference on Conservation Science–New York 2024 (SCCS–NY) is a sister conference to the highly successful SCCS–Cambridge begun in 2000 by the University of Cambridge. Other SCCS conferences now include SCCS–Bangalore, SCCS–Australia, SCCS–Beijing, and SCCS–Hungary.

SCCS–NY 2024 is organized by the American Museum of Natural History's (AMNH) Center for Biodiversity and Conservation (CBC).

SCCS–NY Content and Logistics Coordination:

Suzanne Macey
Kristin Douglas
Ana Luz Porzecanski
Felicity Arengo
Margaret Law
Nadav Gazit
Riley Trist
Peg Watson

Technology Coordinators:

Pete Ersts
AMNH IT Support Team
AMNH AV Support Team

Program Design:

Nadav Gazit

The SCCS–NY Content and Logistics Coordination team would like to thank CBC and Museum staff and the volunteers without whom the conference would not be possible.

Photography and Recording by AMNH

The American Museum of Natural History takes photographs and video footage in its galleries, classrooms, and other public spaces. By attending, you agree the Museum may use photographs and video footage in which you appear for its archival, documentary, promotional, or other purposes. If you prefer to opt out of being photographed or recorded, please see the conference organizers at the SCCS–NY registration desk.

Code of Conduct

The Center for Biodiversity and Conservation (CBC) at the American Museum of Natural History (AMNH) works to promote a welcoming environment at its meetings, whether in virtual or physical spaces, that is safe, collaborative, supportive, and productive for all attendees, including volunteers, exhibitors, and service providers, and that values the diversity of views, expertise, opinions, backgrounds, and experiences reflected among the conference attendees. To that end, we expect all participants—attendees, speakers, mentors, and volunteers—to follow the Code of Conduct during the conference. This includes conference-related social events, and in related online communities and social media. All forms of communication among SCCS-NY 2024 participants during the meeting are considered within the scope of the conference, and thus fall under the jurisdiction of the Code of Conduct. These include public and private communications in virtual conference rooms, via electronic chat functions (e.g., Q/A box, Zoom Chat), emails, texts, social media, phone calls, and other forms of written, verbal, and non-verbal (including visual) communication.

Expected Behavior

- Treat everyone with respect and consideration.
- Communicate openly and thoughtfully with others and be considerate of the multitude of views and opinions that are different than your own.
- Be respectful in your critique of ideas.
- Consider your surroundings and computer screen contents when sharing your screen or appearing in live or pre-recorded videos to prevent the appearance of sensitive personal information, inappropriate background images, or disruptive content. This does not apply to unplanned cameo appearances by pets and children.
- Uphold and support the CBC's commitment and actions to improve the events environmental and social impacts.
- Behave in accordance with professional standards and applicable laws.
- Respect the rules and policies of all venues and online platforms associated with the meeting.

Unacceptable Behavior

- CBC and AMNH do not tolerate discrimination or harassment on the basis of race, creed, color, religion, age, disability, height, weight, marital status, partnership status, gender, sex, sexual orientation, gender identity, gender expression, genetic information, pregnancy, alienage or citizenship status, current or former participation in the uniformed services, status as a veteran, or national, or ethnic origin, or on account of any other basis prohibited by applicable City, State, or Federal law.
- Sexual language and imagery, or any other potentially harassing material or behavior including but not limited to verbal comments, intimidation or unwelcome sexual attention, are not permitted at the conference and may not be incorporated into the visuals or presentations.
- Violating the rules and regulations of the online platforms and services.
- Participants asked to stop any harassing behavior are expected to comply immediately and to not repeat their behavior, or may be required to leave the conference, in the CBC's sole discretion.
- Examples of unacceptable behavior include but are not limited to disruption of virtual meetings, inappropriate comments related to any of the categories listed above; harassing photography or recording; threatening, intimidating or stalking anyone at the conference as an attendee, staff, or presenter or otherwise disruption of talks at the conference or other associated events organized by the CBC.

Consequences

- Anyone requested to stop unacceptable behavior is expected to comply immediately.
- CBC staff (or their designees) may take any action deemed necessary and appropriate, including immediate removal from the conference without warning or refund.
- The CBC reserves the right to prohibit attendance at any future meeting or conference organized by the CBC.

Reporting Unacceptable Behavior

If you are the subject of unacceptable behavior, have witnessed any such behavior, or have any other concerns relating to unacceptable behavior, please immediately notify a CBC staff member or email sccs@amnh.org. Screenshots or any evidence of the concern is helpful but not required.

Finding support at SCCS–NY

- Talk to staff at the Registration Desk or email sccs@amnh.org
- Contact AMNH Title IX officers in Human Resources: Benjamin Marzolf (Director, Human Resources & Title IX Coordinator): 212-769-5316, bmarzolf@amnh.org
- Report prohibited conduct confidentially or anonymously through the Museum's Compliance Hotline, by calling 1-800-620-5571. This 800-number is managed by an outside, independent service provider.

COVID-19 and Community Care at SCCS–NY

We want our on-site events to be as safe and comfortable as possible for participants, staff, and the public.

We strongly recommend on-site participants wear masks and test regularly. KN95 or similar masks and COVID-19 rapid antigen tests will be available at the Kaufmann Desk, and we will have hand sanitizer stations throughout conference spaces. We will have optional low-capacity tables during lunches, and containers (upon request) to facilitate taking your meal outdoors, if preferred.

If you have attended any portion of the conference, and then test positive for COVID-19 during or immediately following the conference, you are expected to report this to the conference staff at sccs@amnh.org. If you need to cancel your participation (in-person or virtual), or switch to virtual participation, please contact the conference staff at sccs@amnh.org. Cancellations due to a positive COVID-19 diagnosis will be eligible for registration reimbursement.

You can find additional guidelines for all American Museum of Natural History guests at the Museum's Health and Safety page: amnh.org/plan-your-visit/covid-19-visitors-staff. If you have questions, concerns, or would like to discuss any accommodation needs, please email sccs@amnh.org.

10:00am– 3:45pm **Registration / Information Desk Open**

*77th Street Lobby
Futter Gallery
Kaufmann Desk*

10:00am **Virtual Workshop**

- What Am I Doing with My Life? Career Planning for Conservation Researchers and Practitioners

*Zoom link available
through the
Participant Site for
virtual workshop
registrants*

11:00am **Collection Tours**

Please arrive 15 minutes early

*Meet at
Linder Theater*

12:00pm **Break: Lunch on Your Own**

1:00pm **On-site Workshops Session 1**

Please arrive 15 minutes early

- Telling Species Stories: Visualizing Futures for North American Habitat Dioramas (Part 1)
- Interactive, Reproducible, and Accessible Species Distribution Modeling for Conservation with Wallace
- Increasing Capacity for Just Language: Reflecting on History and Workshopping New Invasive Species Language and Frameworks

*Meet at
Linder Theater*

3:00pm **Break**

3:30pm **On-site Workshops Session 2**

Please arrive 15 minutes early

- Telling Species Stories: Visualizing Futures for North American Habitat Dioramas (Part 2)
- What Am I Doing with My Life? Career Planning for Conservation Researchers and Practitioners
- Nature's Canvas: The Art and Science of Animal Coloration in Conservation

*Meet at
Linder Theater*

5:30pm **Welcome Event / Meet and Greet**

Coat check closes at 6:15pm

*Anne and Bernard
Spitzer Hall of
Human Origins*

6:30– 8:00pm **Public Program**
SciCafe: Wild in the City

Nina-Marie E. Lister

*Professor, School of Urban + Regional Planning
Director, Ecological Design Lab, Toronto Metropolitan University*

*Dorothy and Lewis
B. Cullman Hall of
the Universe
Lower Level*

9:00am	Registration / Information Desk Open Light Breakfast and Coffee	<i>77th Street Lobby Futter Gallery Northwest Coast Hall</i>
9:30am	Keynote Co-Creating with Nature: Ecology and Design for a Biodiverse Future Nina-Marie E. Lister <i>Professor, School of Urban + Regional Planning Director, Ecological Design Lab, Toronto Metropolitan University</i>	<i>Kaufmann Theater</i>
10:25am	Break	
10:35am	Talk Session: Ecosystem Services and Conservation Moderator: Ana Luz Porzecanski <i>American Museum of Natural History</i> Priya Ranganathan <i>Ashoka Trust for Research in Ecology and the Environment</i> Perceptions of ecosystem services and conservation of <i>Myristica</i> swamps Olivia Boucher <i>University of Hawai'i at Mānoa</i> Cultural ecosystem services and biocultural restoration volunteers in He'eia, Hawai'i Katherine Meier <i>Yale University</i> Swamp patchiness: implications for conservation in a Congolese community reserve	<i>Kaufmann Theater</i>
11:20am	Break	
11:40am	Talk Session: New Approaches in Marine Conservation Moderator: Ann Marie Gawel <i>American Museum of Natural History</i> Kristen Rayfield <i>Stony Brook University</i> <i>Zalophus californianus</i> microbiomes elucidate 130 years of human-animal interactions James Herlan <i>City University of New York</i> Impact of wave exposure on coral dispersion at Rapa Nui Malcolm Tunnell <i>California State University, Monterey Bay</i> Predicting kelp forest loss due to climate change through machine-learning models Chelsi Napoli <i>Stony Brook University</i> Spatiotemporal trends of humpback whale vessel strike risk on the U.S. East Coast	<i>Kaufmann Theater</i>
12:35pm	Break: Transition to Lunch	
1:00pm	Mentor Cafés and Lunch	<i>School Lunch Rooms Lower Level</i>

2:45pm Speed Talk Session: Conservation in the City

Kaufmann Theater

Moderator: Mark Weckel | *American Museum of Natural History*

Brianna Cook | *Bradley University*

How has urbanization affected katydid communication and community structure?

Sophia Lande | *Avenues New York*

Ant biodiversity along an urban gradient across a novel geographic comparison

Altrim Mamuti | *Columbia University*

Species diversity assessment of *Agrilus* jewel beetles in Green-Wood New York City

Sandra Duarte | *Muséum National d'Histoire Naturelle*

Exploring the past to map the present: new records of Cuban wild bees in urban areas

Lily Fillwalk | *Yale University*

Urban green roofs and New York City's equitable climate future

Vallari Sheel | *North Carolina State University*

Urban tree-vertebrate interactions in two megacities in India

Sophie Barno | *Queens College at the City University of New York*

Impacts of drones on urban bats

3:35pm Speed Talk Session: Ecology and Restoration

Kaufmann Theater

Moderator: Viorel Popescu | *Columbia University*

Harriet Barker | *Bradley University*

How have land use and land cover changes affected macro-moth community structure?

Mary Ngugi | *University of Nairobi*

Fire and herbivory interactively suppress survival and growth of trees in Savanna

Sofia Montalvo | *Yale University*

How do cabruacas function? Tree growth, functional traits and biomass in cacao crops

Yeim We | *Yale University*

Impact of eucalyptus reforestation on soil C and nutrients in Atlantic Forest region

Jennica Masigan | *Center For Conservation Innovations Philippines, Inc.*

Green assessment: enhancing post-disaster planning for resilience of island ecosystem

Urmi Poddar | *Stony Brook University*

A novel approach for identifying hotspots of plant invasion

4:30pm End of Virtual Day + Group Photo

5:00 – 7:00pm Poster Session + Pizza Party

*Milstein Family
Hall of Ocean Life*

9:00am	Registration / Information Desk Open Light Breakfast and Coffee	<i>Kaufmann Desk Futter Gallery Northwest Coast Hall</i>
9:30am	Welcome and Announcements	<i>Kaufmann Theater</i>
9:35am	Speed Talk Session: People and Nature Moderator: Adam Jadhav <i>American Museum of Natural History</i> Eduardo Alexandrino <i>Cornell University</i> Scientific impacts of an accidental citizen science initiative in Brazil Aristo Mendis <i>Wildlife Conservation Society</i> Investigating pangolin trafficking in India: a 'crime scripts' approach Naveen David <i>University of Toronto</i> Investigating determinants of environmental values and pro-environmental behaviour Mario Caller <i>Yale University</i> Indigenous People and protected areas conflict in the Peruvian Amazon Hannah Permaul Flores <i>University of Toronto</i> Burnout: changing fire regimes and health in Indigenous Amazonia	<i>Kaufmann Theater</i>
10:10am	Speed Talk Session: Modeling and Managing Species Moderator: Amanda Sigouin <i>American Museum of Natural History</i> Yiqing Wang <i>Peking University</i> Respecting nature, can we expect the leopard's return to modern Beijing? Yucheol Shin <i>American Museum of Natural History</i> Establishment potential of non-native brown frogs (<i>Rana</i>) in the Republic of Korea Nobin M <i>Ashoka Trust for Research in Ecology and the Environment</i> Interdisciplinary perspectives on <i>Gambusia spp.</i> in India: genetics, SDM, and policy Alice Wang <i>Barnard College, Columbia University</i> Plant presence of spotted lanternfly across insect life stages in New York Junyan Wang <i>University of California, Davis</i> The sustainable management of caterpillar fungus in Sanjiangyuan areas	<i>Kaufmann Theater</i>
10:45am	Break	

11:00am **Talk Session: Conserving Species in Human-Dominated Landscapes** *Kaufmann Theater*
Moderator: **Jemima Georges** | *American Museum of Natural History*

Devendra Dutta Pandey | *Independent researcher*
Impacts of free-ranging dogs on native wildlife in a human-dominated desert

Priyanka Justa | *Wildlife Institute of India*
Free-ranging dogs: threat to wild predators

Ana Maria Saldarriaga | *Fordham University*
Reintroduction of Orinoco crocodiles in Colombia: towards the species' recovery

Ananya Rao | *Yale University*
Charismatic animals and displaced people in the protected areas of Kodagu, India

11:50am **Break**

12:05pm **Talk Session: Conservation Genetics, Genomics, and Health** *Kaufmann Theater*
Moderator: **Melina Giakoumis** | *American Museum of Natural History*

Madison Lichak | *Princeton University*
Genomic assessment of a tusk reintroduction effort in Addo Elephant National Park

Seth Cunningham | *Fordham University*
Conservation genomics of a unique crocodile population in the Sahara

Keerthipriya Palanivel | *Colorado State University*
Associations of the endangered koloa maoli and the role of plumage and relatedness

Amanda Johnston | *Columbia University*
Effect of habitat loss on helminth infection in wild golden monkeys in Rwanda

1:00pm **Break: Transition to Lunch**

1:15pm **Mentor Cafés and Lunch** *School Lunch
Rooms
Lower Level*

2:45Pm Speed Talk Session: Genetics and Genomics in Conservation

Kaufmann Theater

Moderator: Aaron Goodman | *American Museum of Natural History*

Jong Yoon Jeon | *Purdue University*

How can genomic information inform conservation efforts?

Sabmeet Singh | *Maharaja Ganga Singh University*

Conflict and genomics of tiger and leopard, at Jim Corbett National Park, India

Mai Fahmy | *Fordham University*

From rags to riches: methods and applications of eDNA for biodiversity monitoring

Lindsey Hauff | *Rutgers University*

De novo genome assembly for endangered lemur using portable sequencing in Madagascar

Hayley Geyle | *Charles Darwin University*

Using non-invasive genetic surveys to estimate abundance of a threatened marsupial

Danielle Lema | *Fordham University*

Reconciling mitochondrial-nuclear discordance in African leopards (*Panthera pardus*)

3:25pm Speed Talk Session: Species Ecology and Conservation

Kaufmann Theater

Moderator: Mary Blair | *American Museum of Natural History*

Laura Girón | *Universidad del Valle*

Short-term humpback whales' behavior in the presence of touristic vessels in Colombia

Lucy Holland | *Columbia University*

Spatial ecology and habitat selection of translocated European bison

Mariah Jose Dichoso | *Department of Environment and Natural Resources, Philippines*

Whispers in the night: decoding the enigmatic language of Philippine microbat calls

Nicolás Herrera | *Universidad del Valle*

Skin health status of the cetacean community in the Gulf of Tribugá, Colombia

Ritika Sibal | *Boston University*

Assessing locomotor ontogeny in wild Bornean orangutans using computer vision

4:05pm Break

4:15pm

Careers Panel: Exploring Diverse Paths in Conservation

Kaufmann Theater

Opening remarks: Sean M. Decatur | *President, American Museum of Natural History*

Moderator: Ana Luz Porzecanski | *American Museum of Natural History*

Melissa Abramson

*National Field Marketing Manager
REI*

Melissa is the National Field Marketing Manager for REI. Forming strong partnerships with local non-profits, government, and land agencies has been the cornerstone of her work, in an effort to promote conservation and equitable access to nature for all, both in the greater New York area along with the nation.

She is committed, both personally and professionally, to equity in the outdoors, exploration, education, and stewardship. She has worked in Brazil, Costa Rica and the Pacific Northwest, designing adventure-based Leadership Education programs for both youth and adults. After receiving her master's degree in economics and social policy and planning from the London School of Economics, she planted roots in New York City to create a direct pathway for urban dwellers to access nature and ultimately taking a vested interest in protecting and preserving public green spaces.

Most recently, she has founded the New York Outdoor Recreation Coalition, providing a unified voice of outdoor enthusiasts for New York's diverse user groups across the industry.

Christian Rivera

*Postdoctoral Research and Teaching Associate
Princeton University's High Meadows Environmental Institute*

Christian is an Environmental Teaching Fellow and Postdoctoral Research Associate in the High Meadows Environmental Institute at Princeton University and a Visiting Scientist at the Center for Biodiversity and Conservation. His interdisciplinary research program draws on his training in ecology, evolution, and conservation biology and the conservation social sciences. Rivera's work aims to advance theory and practice under three broad themes: human-wildlife relations and interactions, dynamics of social-ecological systems, and conservation science. He has over ten years of experience working on issues of endangered species conservation, wildlife hunting and trade, biocultural approaches to conservation, and ethnoprimateology in the U.S., Southeast Asia, and Latin America.

Rivera's current research integrates approaches in anthropology and conservation biology to understand issues of wildlife utilization, consumption, and trade in human-dominated environments, notably in the urbanizing Amazon and New York City. His work applies social-ecological systems approaches towards the conservation of biological and biocultural diversity in a rapidly changing, interconnected, and urbanizing world. At Princeton he teaches courses on interdisciplinary conservation science.

Neha Savant

*Wildlife & Fisheries Ecologist
NYC Department of Parks & Recreation*

Neha Savant is an urban wildlife ecologist, storyteller and facilitator dedicated to building and maintaining the enabling conditions for biodiversity, relational difference, and pluralism to thrive, especially in peopled landscapes. As a part of the Natural Resources Group within the division of Environment & Planning, she conducts wildlife and ecological monitoring across the city, provide comments on environmental reviews and give presentations on NYC Parks' work to various audiences.

5:30–
6:30pm

Awards and Closing Reception

Hall of Mexico and
Central America

Keynote Speaker

Nina-Marie E. Lister

Professor, School of Urban + Regional Planning

Director, Ecological Design Lab, Toronto Metropolitan University

Co-Creating with Nature: Ecology and Design for a Biodiverse Future

The science of ecology and the art of design offer promising intersections and—from these—new solutions to the entangled challenges of climate change and biodiversity loss. Ecological Design is an emerging transdisciplinary field that my work has advanced over two decades of research and practice. As a field ecologist and a landscape designer, I integrate research approaches across conservation biology, landscape architecture and structural engineering to inform new working methods and to develop applied solutions. In this talk, I'll share transformative projects that have resulted from surprising collaborations with unexpected partners across a diversity of disciplines. These projects have catalyzed and advanced new opportunities to co-create and implement nature-based solutions for both climate resilience and biodiversity recovery.



Conference participants and mentors can access presentation recordings and posters on the conference platform, available until November 15th, 2024.



<https://resources.cbc.amnh.org/sccsny>

A list of all talk, speed talk, and poster presentations—including authors and co-authors, titles, and abstracts—can be found on the conference website.



amnh.org/sccsny

Poster Presenters

Esther Adinda

Little Fireface Project

Sarah Apgar

Kean University

Angel Arizia, Angelina Freyre, Sanny Zhang

Science Research Mentoring Program

Jacob Berman

Cornell University

Isabella Birjandi

Pace university

Clara Brandon

University of Michigan

Kevin Castro

St. Francis College

Moumita Chakraborty

Wildlife Institute of India

Alex Chauncey-Heine

Princeton University

Christine Cieslak

Oregon State University

Shuchismita Das

Amity University

Mpayimana Delphine

University of Rwanda

Liam Engel

Fordham University

Erica Feldman

Stony Brook University

Mai Fahmy

Fordham University

Annie Finneran

Rice University

Shawn Fujioka

Columbia University

Laura Haynes

University of Massachusetts Amherst

Brian Kaelo

Catawba College

Jared Kannel

Columbia University

Anjuri Kakakr

Yale University

Caden Klopfenstein

Iowa State University

Sasha Koulakova

Stony Brook University

Oliver Krieger

Queens College

Charlotte Kunesh

Princeton University

Fen Levy

Tufts University

Siqi Liang

Duke University

Carlee Lingle

United States Coast Guard Academy

Molly McCargar

Fordham University

Tyler McMahon

Bradley University

Fatima Meza Prudencio

St. Francis College

Dimitri Mimy

Queens College

Mads Moore

Columbia University

Dani Pergola

Columbia University

Sophie Roberts

Yale University

Katharine Rush

Fordham University

Indah Sari

Universitas Muhammadiyah Palangkaraya

Marsya Sibarani

University of Michigan

Poster Presenters

Harita Sistu

University of Massachusetts Amherst

Kyriana Tarr

NYC Bird Alliance

Anne Tong

Harvard University

Samantha Tracy

Yale University

Sophia Vrh

Cold Spring Harbor Laboratory

Connor Whalen

University of Washington

Emma Witanowski

Villanova University

Chenjie Xia

Columbia University

SCCS-NY Advisors, Reviewers, Mentors

Lise Aangeenbrug

National Park Foundation

Melissa Abramson

Recreational Equipment Inc & New York Outdoor
Recreation Coalition

Matthew Aiello-Lammens

Pace University

Dan Ardia

Franklin & Marshall College

Felicity Arengo

American Museum of Natural History

Eleanor Austria

Adamson University

Anuradha Batabyal

FLAME University

Erin Betley

American Museum of Natural History

Mark Birchette

American Museum of Natural History

Mary Blair

American Museum of Natural History

Adriana Bravo

University of Toronto

Bekka Brodie

Columbia University

Angela Camargo

Universidad Autónoma de Chihuahua

John Cigliano

Cedar Crest College

Joanna Coleman

Queens College

Christina Colon

Kingsborough Community College

Sunny Corrao

NYC Parks

Antonio Crespo

Universidad Del Azuay

Nicholas Cuba

Auburn University at Montgomery

Georgina Cullman

NYC Parks

Anthony Cummings

University of Texas at Dallas

Erika Deinert

Washington State University – Vancouver

Zorabel Maria Delos Reyes

Adamson University

Kristin Douglas

American Museum of Natural History

Diego Ellis Soto

Yale University

Andrew Farnsworth

Cornell University

SCCS-NY Advisors, Reviewers, Mentors

Joyce Fassbender

Florida Gulf Coast University

Denny Fernandez del Viso

University of Puerto Rico – Humacao

Helen Fox

Coral Reef Alliance

Nicholas Friedenber

Corteva Agriscience R&D

Ishita Ganguly

Gastrobile Healthcare Private Limited

Stephen Gaughran

Princeton University

Maria Mercedes Gavilanez

Central University of Ecuador

Ann Marie Gawel

American Museum of Natural History

Nadav Gazit

American Museum of Natural History

Denise Gemmellaro

Kean University

Laura German

University of Georgia

Melina Giakoumis

American Museum of Natural History

Anthony Giordano

S.P.E.C.I.E.S.

Andres Gomez

DAI

Martha Groom

University of Washington Bothell & Seattle

Kristi Hannam

State University of New York at Geneseo

Martha Hurley

Re:wild

Rehan Ul Haq

University of Veterinary and Animal Sciences, Lahore

Ned Horning

Regen Network Development PBC

Jeremy Jackson

American Museum of Natural History

Meghan Kautzer

University of Wisconsin-Madison

Francine Kershaw

Natural Resources Defense Council

Tom Langen

Clarkson University

Jenna Lawrence

Columbia University

Eric LeFlore

Bates College

David Lohman

City College of New York

Suzanne Macey

American Museum of Natural History

Simo Maduna

Norwegian Institute of Bioeconomy Research

Reiko Matsuda Goodwin

Fordham University

Erin McGauley

Fleming College

Miramanni Mishkin

Universidad Nacional Autonoma de Mexico

John Mull

Weber State University, College of Science

Eugenia Naro-Maciell

New York University

Johanna Ochoa Ruilova

Universidad Del Azuay

Oluwafemi Jacob Orimaye

National Open University of Nigeria

Matt Palmer

Columbia University

Katie Paolantonio

New York University

Jennifer Phillips

Bard Center for Environmental Policy

SCCS-NY Advisors, Reviewers, Mentors

Ana Luz Porzecanski

American Museum of Natural History

Simon Queenborough

Yale University

Jessica Rothman

Hunter College

Anne Ricculi

Drew University

Christoph Richter

University of Toronto Mississauga

Shelby Riskin

University of Toronto

Christian Rivera

Princeton University

Dan Rubenstein

Princeton University

Manette Sandor

Columbia University; American Museum of Natural History

Neha Savant

NYC Parks

Robin Sears

Williamstown Rural Lands

Maria Shumskaya

Kean University

Amanda Sigouin

American Museum of Natural History

Julia Smachylo

University of Connecticut

Maria Strangas

American Museum of Natural History

John Tanacredi

Molloy University

Anne Toomey

Pace University

Ursula Valdez

University of Washington Bothell

Erin Vogel

Rutgers University

Mark Weckel

American Museum of Natural History

Judith Weis

Rutgers University

Maureen Williams

McDaniel College

Dana Williams

Williamstown Rural Lands

Museum Map

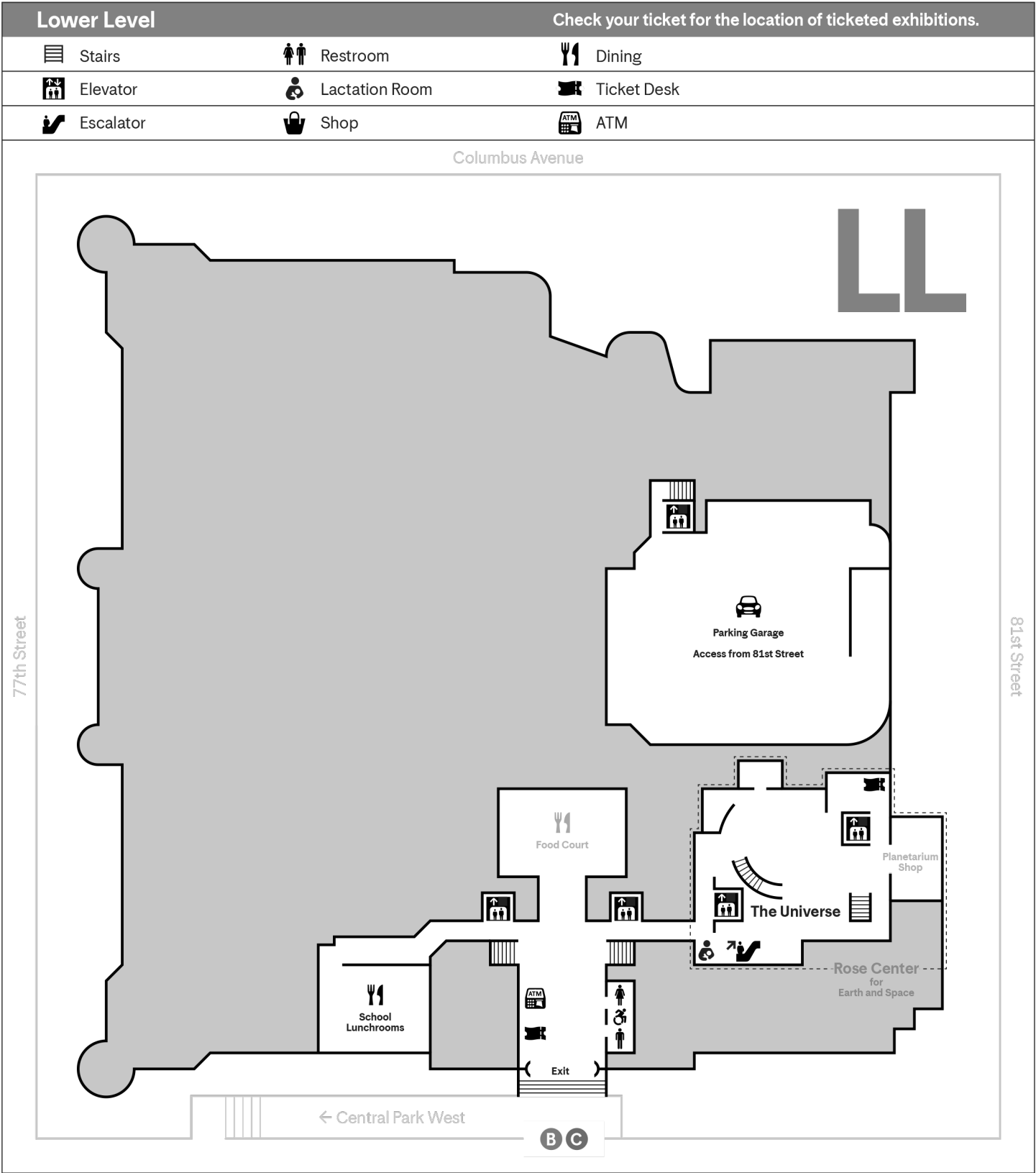

Museum Map

Floor 1

Check your ticket for the location of ticketed exhibitions.

 Stairs	 Restroom	 Dining	 Ticket Desk
 Elevator	 Family/All-Gender Restroom	 Shop	 Membership Desk
 Escalator	 Companion Care Room	 Classroom	 Information Desk

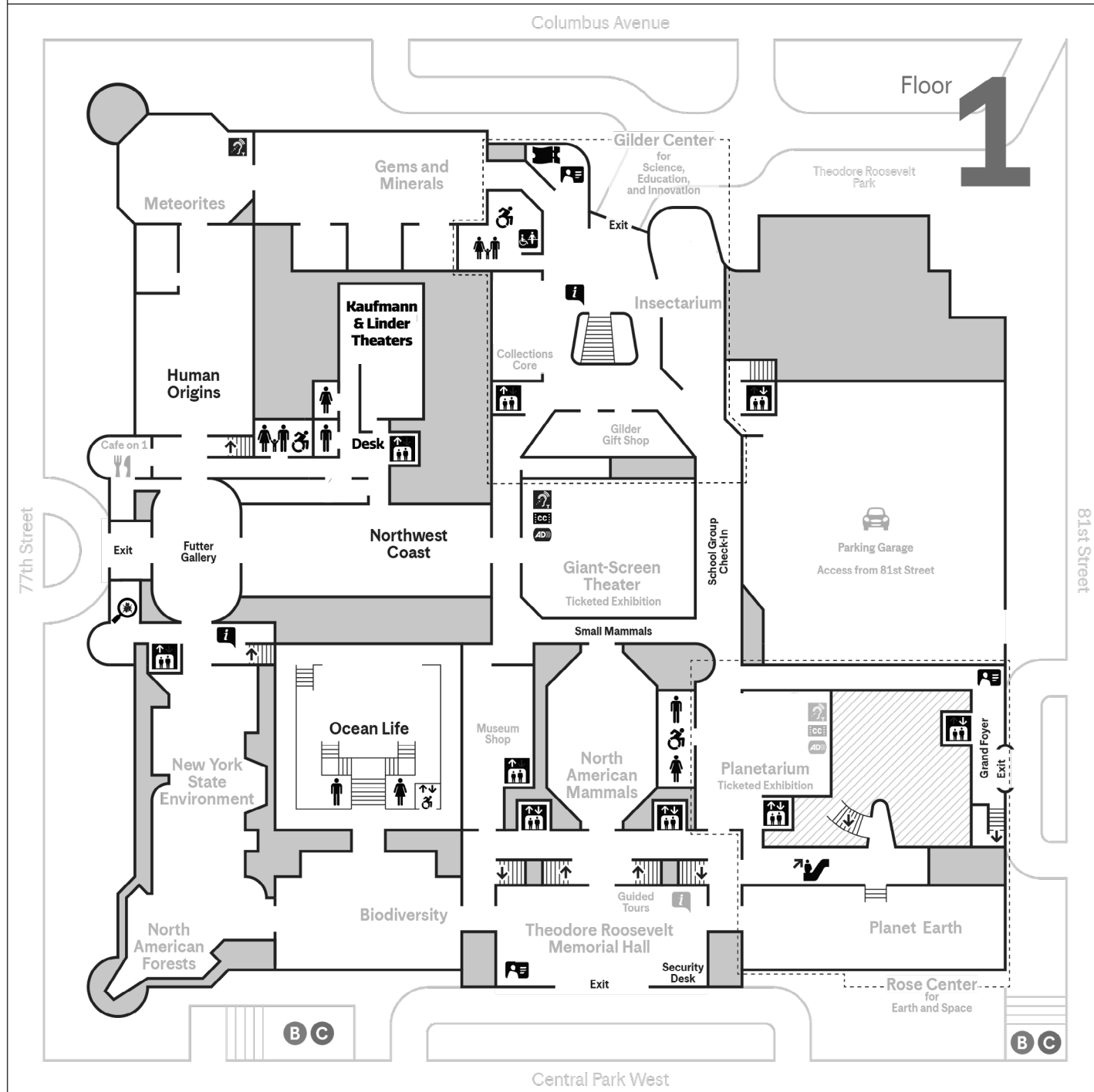



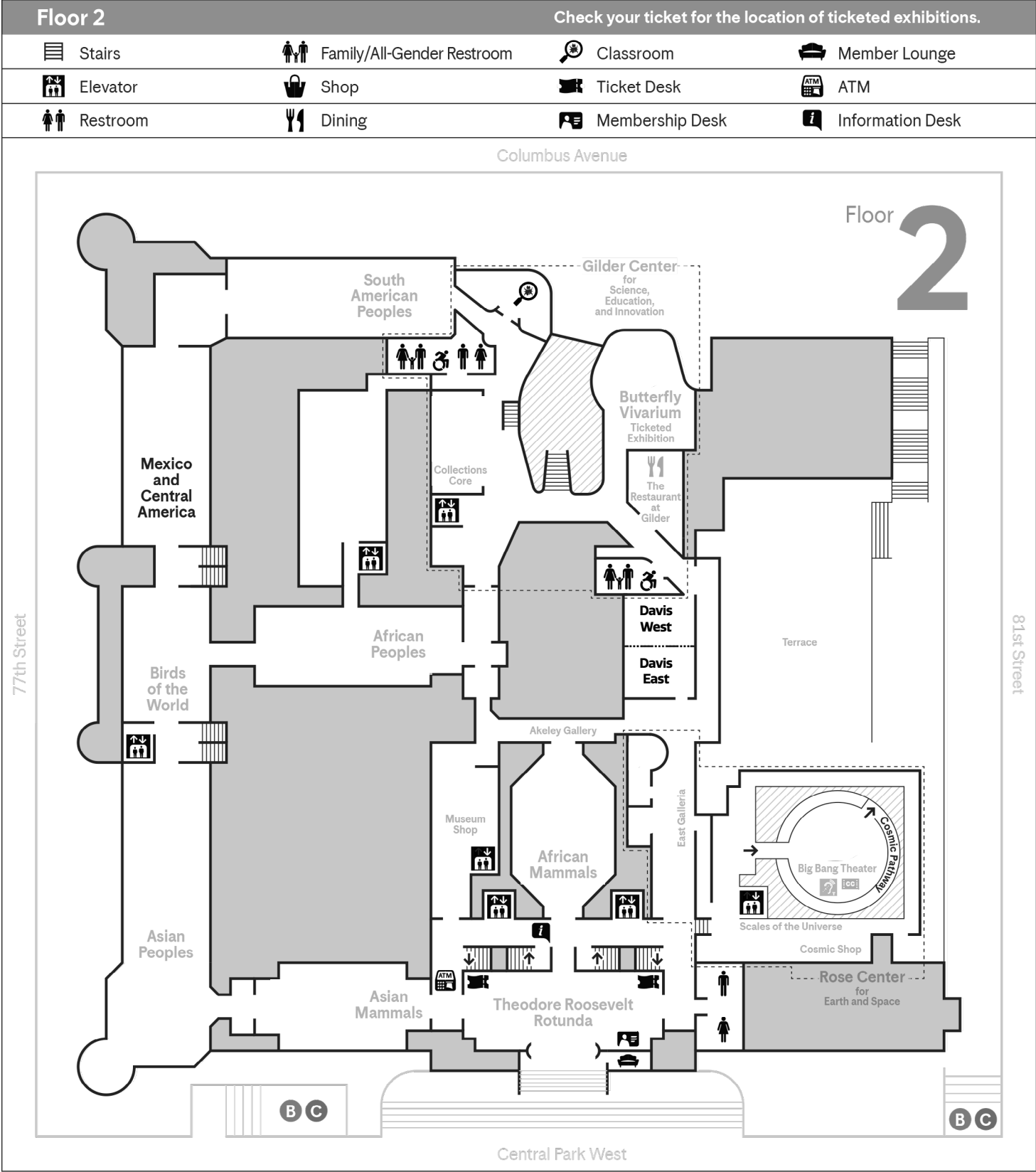

Museum Map



Museum Map

Floor 3

Check your ticket for the location of ticketed exhibitions.

 Stairs	 Restroom	 Shop
 Elevator	 Family/All-Gender Restroom	 Classroom
 Escalator	 Lactation Room	 Information Desk

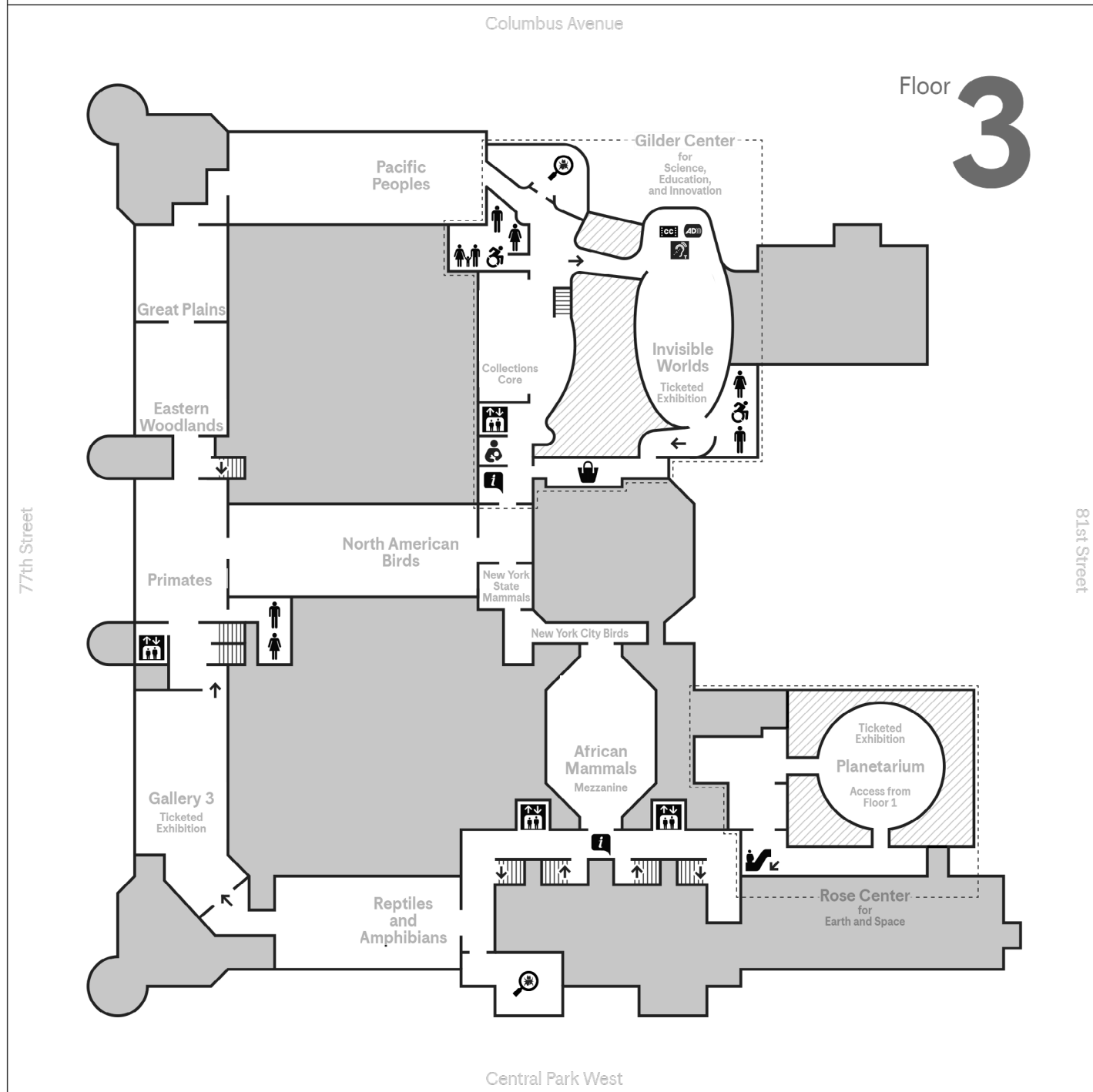

Museum Map

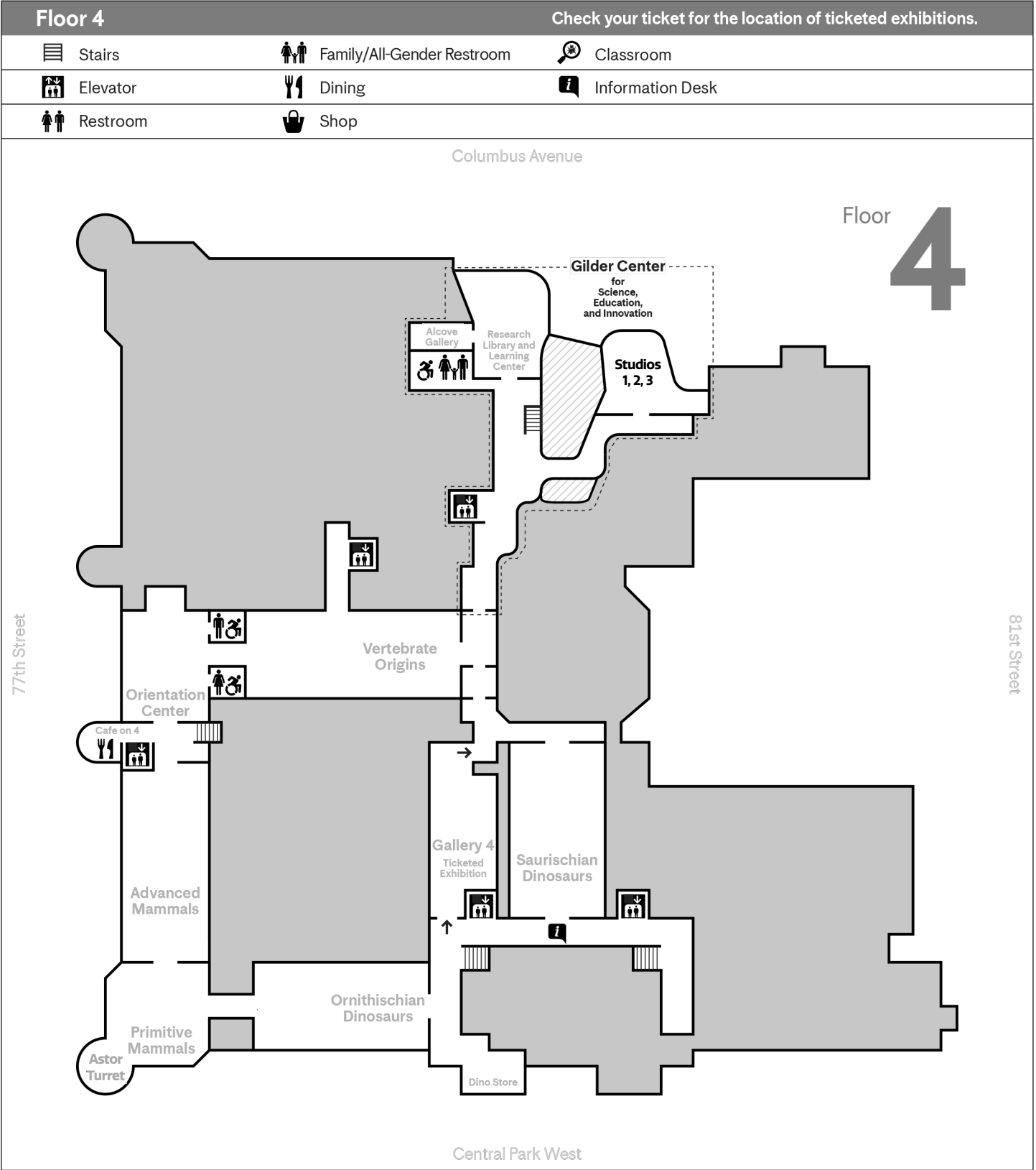

About SCCS–NY Content

SCCS–NY is designed to foster dialogue and collaboration between the students, postdoctoral fellows, early-career professionals, and established conservationists in attendance. We care deeply about preserving the integrity of the work, research, and personal interactions of our speakers, mentors, presenters, and attendees. In order to find a balance between the expectations of presenters and attendees, and to make the meeting a safe and comfortable space for everyone, we have some basic guidelines. Please keep in mind CBC's meeting Code of Conduct and apply it to your written and oral communication. Harassment, intimidation, or discrimination in any form will not be tolerated. Our speakers and presenters have invested considerable time and effort in the development of their material and copyright laws apply. We encourage open discussion on social media and ask attendees to share the science and ideas presented at SCCS with their followers. However, we ask that you be especially cautious about discussing the work that is being presented. Due to the nature of this conference you may be hearing about new or unpublished work that may not be suitable for sharing. If you choose to write about the conference following the scheduled sessions, you must gain approval from speakers/presenters prior to quoting, publishing, or otherwise referencing their research on the Internet or through other forms of media.

The Center for Biodiversity and Conservation

Understanding life on Earth and how to sustain it for the future is the fundamental challenge of our time. The American Museum of Natural History is devoted to understanding our universe, our planet, and our role as humans. Through its Center for Biodiversity and Conservation (CBC), the Museum acts on that understanding and advances our collective endeavor of learning to live in harmony with nature. Our work aims to bring strong evidence—from multiple sources of knowledge and perspectives—to bear on complex conservation challenges, and to foster collaboration on robust, innovative, and equitable solutions. The challenge is both scientific and social, so we work by connecting different strands of knowledge in our research, connecting people to knowledge, and connecting people to each other.